

# GROWONIX

TUNED FOR GROWING



## XL-SCRUB DE-CHLORINATOR OWNERS MANUAL

[WWW.GROWONIX.COM](http://WWW.GROWONIX.COM)



1:1

## FEATURES

-  150 GALLONS PER DAY
-  6.25 GALLONS PER HOUR
-  2:1 WASTE RATIO
-  DOW CHEMICAL MEMBRANE
-  CATALYTIC CARBON FILTER
-  EZ HOOKUP KIT
-  9-STAGE ALKALINE  
REMINERALIZING FILTER
-  USES 50% LESS WATER THAN  
TRADITIONAL RO SYSTEMS
- 



Built in the U.S.A.



**XL-SCRUB**

**FREE WARRANTY**  
**1 YEAR PARTS & LABOR**  
**SEE WEBSITE FOR DETAILS**

w/ **HIGH FLOW**



**COLD WATER  
MEMBRANE**



**NO ADDITIONAL PRE-FILTERS NEEDED.**

# TABLE OF CONTENTS

- 2** FEATURES
- 3** TABLE OF CONTENTS
- 4** OUR MISSION
- 5** INFORMATION ON QUICK CONNECT FITTINGS
- 6** XL-SCRUB COMPONENT DIAGRAM
- 7** XL-SCRUB SETUP INSTRUCTIONS
- 8** REPLACING SEDIMENT AND CARBON PRE-FILTERS
- 9** XL-SCRUB SPECIFICATIONS CHARTS
- 10** FLUSHING THE KDF85 CARBON FILTER
- 11** GROWONIX ACCESSORIES
- 12** PRESSURE DIFFERENTIAL CHART
- 13** GROWONIX WARRANTY / RETURN POLICY

**GROWONIX**   
TUNED FOR GROWING



## OUR MISSION

Durability, Reliability, Efficiency, Purity, and Conservation form the foundation on which we design and build all of our products. Consistent and superior quality sets us apart from other manufacturers and increases our value to you - our customer. Whether you are a hydroponics hobbyist, serious enthusiast, or large-scale gardener, GrowoniX is committed to bringing you the best solution for water purification systems.

## WHY USE A GX SCRUBBER ?

Chlorine, Chloramine and Chloride are but a few of the chemicals added to municipal water sources to kill harmful bacteria in our drinking water. This chlorine in low doses may not harm humans, but will kill beneficial bacteria and micro organisms essential for healthy plant growth. Our EX Scrub de-chlorinator will eliminate 95% of the chlorine in the water, and 90% of the sediment.

Chloramine, a mix of chlorine and ammonia, used as a disinfectant, is being applied more and more to local water supplies because of its inability to evaporate when left in the air. Chloramine will not evaporate. To eliminate chloramine, a special KDF filter is required for the EX Scrub which GrowoniX or your local dealer can supply. Ask for the GrowoniX KDF filter.

The GX Scrubber will not lower your parts per million or “ppm”. Only a Reverse Osmosis membrane can eliminate those particles. GrowoniX sells a complete line of Reverse Osmosis water filters from 100 gallons per day all the way up to 2000 gallons per day. You can see our complete product line at [www.growonix.com](http://www.growonix.com).

## FLOW RATES AND FILTER REPLACEMENT

The GX Scrubber can filter up to 8000 gallons of water before changing filters, based on 2 gallons per minute with 1ppm of chlorine. You may need to replace your filter more frequently if your water is heavily contaminated.

## PRECAUTIONS

- Do not use unit with inlet water pressure exceeding 80 psi. If inlet water pressure is too high, install water pressure regulator before the unit. Regulators and pressure limiters are available at [www.Growonix.com](http://www.Growonix.com) or your local plumbing supply.
- Keep unit away from direct light. Direct light can cause algae and other biologicals to grow inside of the filter housings.
- Do not install unit near electrical outlets or electrical devices. Do not install in places where a leak can cause damage.

# INFORMATION ON QUICK CONNECT FITTINGS

## GROWONIX WATER FILTERS USE QUICK CONNECT FITTINGS THAT ALLOW FOR EASY MAINTENANCE.

### MAKE A CLEAN TUBE CUT

Cut the tube squarely and if using plastic tubing, ensure that the cut has not made the tube out of round. Also ensure that the tube has a smooth outside diameter without any burrs or score marks prior to inserting it into the fitting.

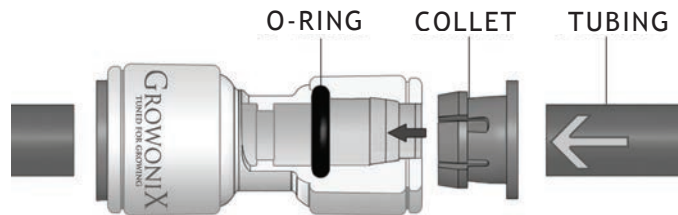

### INSERT TUBE INTO FITTING

Push the tubing through the collet and dual o-rings until it bottoms out against the tube stop. The collet holds the tube in place and the dual o-rings provide a leak resistant seal.

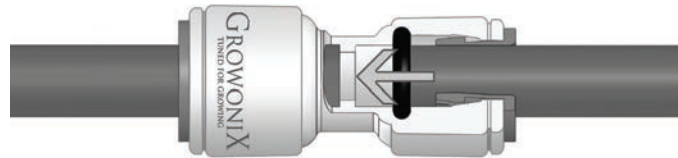

### TEST AND INSPECT

Push and pull the tubing toward and away from the fitting to ensure that it has been installed properly. Test and inspect the installation for any leaks.

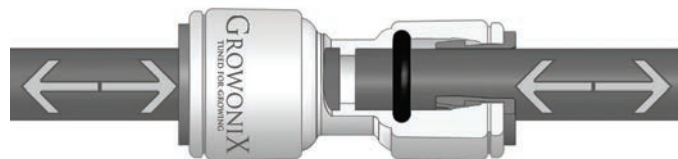

### TUBE REMOVAL

Relieve pressure from the tubing and fitting. Push uniformly around the collet flange against the fitting body while pulling the tubing away from the fitting to release it.

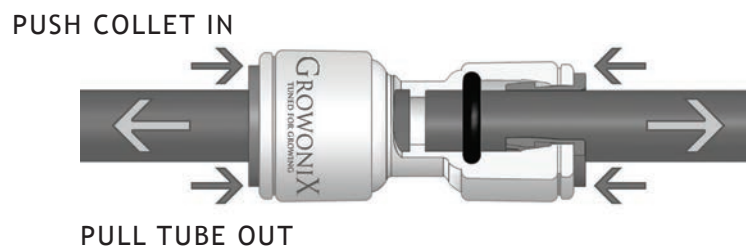

# FLOW RATES

## 100GPD – 400GPD FILTER FLOW RATES

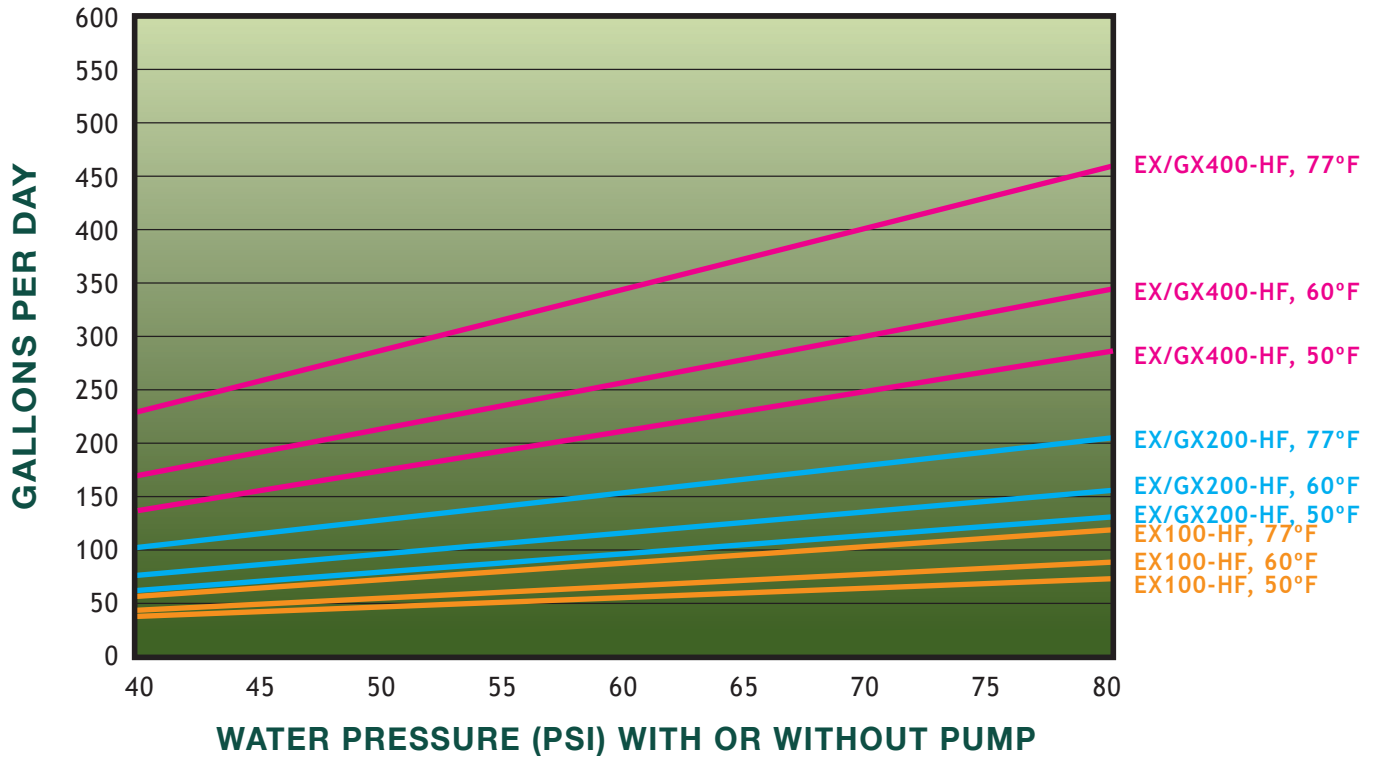

## 600GPD – 1000GPD FILTER FLOW RATES

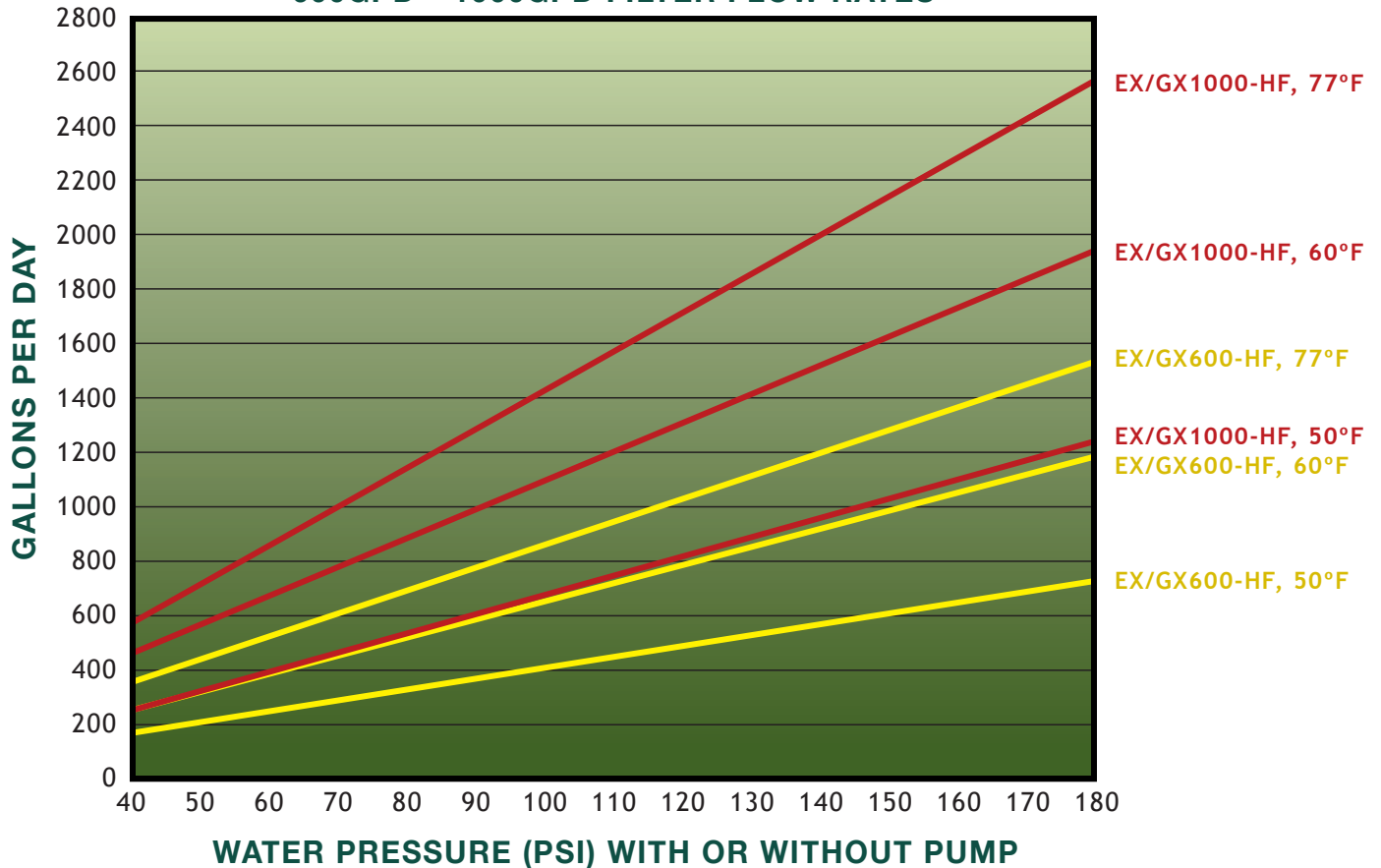

# REPLACEMENT PARTS

## MEMBRANE INDEX

-  **COCONUT CARBON FILTER— “GREEN BLOCK”**  
PREMIUM COCO CARBON, PRODUCED USING ECO-FRIENDLY LOW EMISSIONS PROCESSES
-  **COCONUT CARBON FILTER— ”WHITE BLOCK”**  
ECONOMY COCO CARBON, SAME PERFORMANCE AS GREEN BLOCK, FOR A LITTLE LESS MONEY.
-  **KDF85/CATALYTIC ACTIVATED CARBON FILTER**  
PREMIUM CARBON FILTER USING THE BEST ACTIVATED CARBON WITH A BED OF KDF85 MEDIA. THERE'S NO BETTER CARBON AVAILABLE.
-  **SEDIMENT SPUN**  
SPUN POLY SEDIMENT FILTERS WITH HUGE DIRT HOLDING CAPACITY.
-  **SEDIMENT PLEATED**  
HIGH FLOW SEDIMENT FILTERS WITH ULTRA LOW PRESSURE DROP.
-  **GXM INDUSTRIAL MEMBRANES**  
HIGHEST FLOWING DOW SHEET MEMBRANES ON THE PLANET, WITH THE LOWEST WASTE RATIO.
-  **GXM HIGH FLOW COLD WATER MEMBRANES**  
HIGHEST FLOWING RESIDENTIAL SIZED MEMBRANES. ALWAYS 2:1 RATIO.
-  **ALKALINE INLINE**  
INLINE FILTER ADDS CALCIUM & MAGNESIUM TO FILTERED WATER, RAISES THE PH.
-  **ALKALINE CARTRIDGE**  
CARTRIDGE ADDS CALCIUM & MAGNESIUM TO FILTERED WATER, RAISES THE PH.
-  **REMINERALIZING INLINE**  
INLINE FILTER ADDS CALCIUM & MAGNESIUM TO FILTERED WATER,
-  **REMINERALIZING CARTRIDGE**  
CARTRIDGE ADDS CALCIUM & MAGNESIUM TO FILTERED WATER,
-  **UV STERILIZATION**  
KILLS 99.9% BACTERIA AND VIRUSES.
-  **DI INLINE**  
DE-IONIZATION FILTER REMOVES LAST BIT OF PPM.

## NEW GXM-600 & 1000 MEMBRANES!

30% INCREASED FLOW RATE

98.5% REJECTION

1:1  
RATIO



GXM-1000HF 1000GPD@60PSI · 2400 GPD@180 PSI

GXM-600HF 600GPD@60PSI · 1400 GPD@180 PSI

FLOW RATED AT 65°F WATER TEMPERATURE

PRODUCT	TYPE	MSRP	SYSTEM	NOTES
---------	------	------	--------	-------

SPECIALTY FILTRATION, ACCESSORIES & REPLACEMENTS				
ALK-Inline	Alkaline	99.00	All RO systems	Raises ph, adds cal/mag mineral.
ALK-Cart	Alkaline	99.00	All RO systems	Raises ph, adds cal/mag mineral.
RM-Inline	Re-Mineralize	67.00	All RO systems	Adds cal/mag minerals.
RM-CART	Re-Mineralize	67.00	All RO systems	Adds cal/mag minerals.
DI-Inline	De-Ionization	31.00	All RO systems	Removes remaining TDS after RO (aquarium, lab)
DI-Cart	De-Ionization	34.00	All RO systems	Removes remaining TDS after RO (aquarium, lab)
UV-1530	Ultraviolet	149.00	All RO, Scrubber systems, tank storage	Kills 99.9% bacteria
UV-6010	Ultraviolet	215.00	All RO, Scrubber systems, tank storage	Kills 99.9% bacteria / viruses
UV-LB	Ultraviolet	443.00	All RO, Scrubber systems, tank storage	Kills 99.9% bacteria / viruses
UV-XL	Ultraviolet	538.00	All RO, Scrubber systems, tank storage	Kills 99.9% bacteria / viruses

PRODUCT	TYPE	APPLICATION / SYSTEM	MSRP	CAPACITY	NOTES
REPLACEMENTS FOR ALL WATER FILTERS 400 GPD AND UNDER					
SF-2510-PL	Sediment Pleated	EX100/200/400/400-Tall, GX200/300/400, Mini Scrub	14.50	Depends on feed water piping/supply	Stock on GX Series
SF-2510-SP	Sediment Spun	EX100/200/400/400-Tall, GX200/300/400, Mini Scrub	10.75	Depends on feed water piping/supply	Stock on EX Series
CF-2510-CC	Economy Coco Carbon	EX100/200/400/400-Tall, GX200/300/400, Mini Scrub	12.00	7,500 Gallons Total 2,500 Gallons RO Water	Stock on EX Series
CF-2510-GB	Green Carbon	EX100/200/400/400-Tall, GX200/300/400, Mini Scrub	16.50	7,500 Gallons Total 2,500 Gallons RO Water,	Stock on GX Series
CF-2510-KDF	Premium Carbon	EX100/200/400/400-Tall, GX200/300/400, Mini Scrub	39.00	8,000 Gallons Total 2,700 Gallons RO Water	Must for well water and chloramine removal
GXM-100	Standard Membrane	100+ GPD membrane for EX100	83.00	Depends on feed water quality	Fits most other RO systems
GXM-200-HF	High Flow Cold Water Membrane	200+ GPD High Flow Cold Water Membrane for EX100/200/400/400-Tall, GX200/300/400	99.00	Depends on feed water quality	Fits most other RO systems
BP-1530	Booster Pump	Booster pump for all RO systems 600 GPD and under.	227.00	12,000 Hrs brush life	Booster pump for all RO systems 600 GPD and under

REPLACEMENTS FOR EX400HF-TALL AND SLIMSCRUB					
SF-2520-SP	Sediment Spun	EX400-tall, Slim Scrub	10.75	Depends on feed water piping/supply	
CF-2520-CC	Economy Coco Carbon	EX400-tall, Slim Scrub	24.00	16,000 Gallons Total 5,300 Gallons RO Water	
CF-2520-KDF	Premium Carbon	EX400-tall, Slim Scrub	71.00	17,000 Gallons Total 5,700 Gallons RO Water	Must for well water and chloramine removal
CF-4520-KDF	Premium Carbon	EX600/1000-Tall, XL Scrub	127.00	34,000 Gallons Total 17,000 Gallons RO	Must for well water and chloramine removal

# XL-SCRUB COMPONENT DIAGRAM

## FEATURES

- Scrub out 99% of chlorine
- Scrub out 90% of sediment
- Filter capacity of 16,000 gallons
- 3 gallons per minute flow rate
- 5 micron sediment filter
- Eco coconut carbon filter
- EZ Hookup Kit
- Wall Mountable
- Brass garden hose connection included

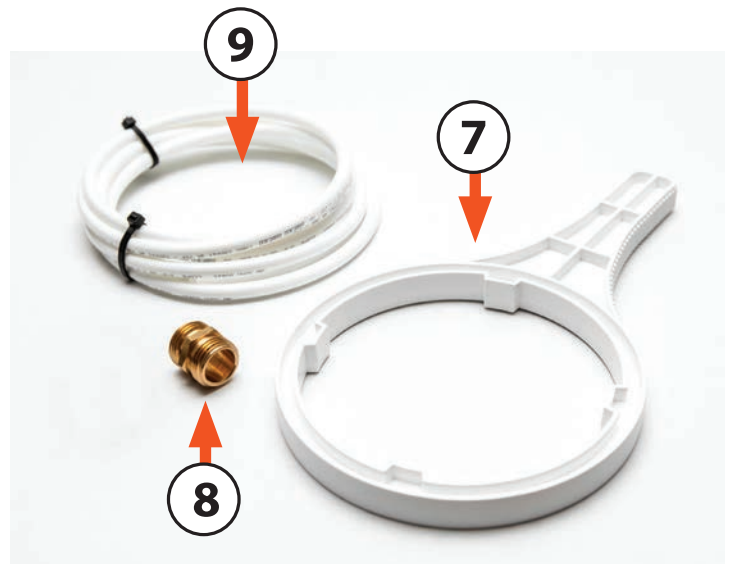

1. INPUT PRESSURE GAUGE
2. OUTPUT PRESSURE GAUGE
3. SEDIMENT FILTER
4. CARBON FILTER
5. SUPPLY WATER IN  
{GARDEN HOSE ADAPTER}
6. PRODUCT WATER OUT
7. FILTER WRENCH
8. BRASS GARDEN HOSE COUPLER
9. 5' LENGTH OF 3/8" TUBING

# XL-SCRUB SETUP INSTRUCTIONS

## IMPORTANT TIPS:

- The XL-Scrub de-chlorinator is designed to be used between 40-80 psi of incoming water pressure.
- Do not exceed 80 psi of incoming water pressure. If incoming water pressure is too high, install pressure regulator before unit. Pressure regulators are available at [www.GrowniX.com](http://www.GrowniX.com)
- Always turn incoming water pressure on slowly, allowing all air to be discharged before full water pressure is restored.



Connect your Garden hose to the Brass Garden Hose Swivel connector on inlet side of your XL-Scrub

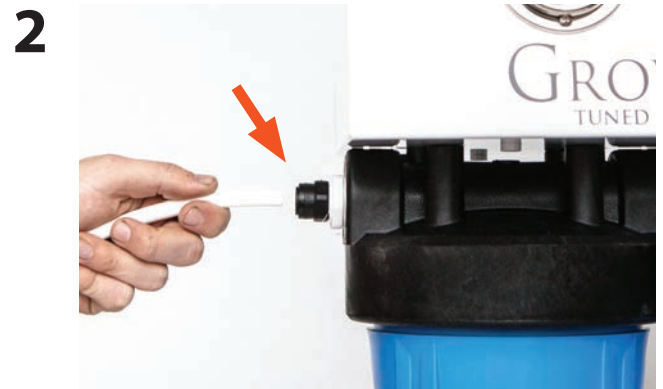

Connect the 3/8 tubing to the quick connect fitting on the outlet side of your XL-Scrub

**3** Turn water on slowly.

# REPLACING SEDIMENT AND CARBON PRE-FILTERS XL-SCRUB

## IMPORTANT TIPS:

- Pre-filters should be changed when either brown discoloration occurs, or system flow rates have significantly declined.
- Always turn incoming water pressure off before servicing the unit.
- Always turn incoming water pressure on slowly, allowing all air to be discharged before full water pressure is restored.



Unscrew sediment and carbon filter housings using supplied filter wrench. Wash inside of filter housings to remove debris.

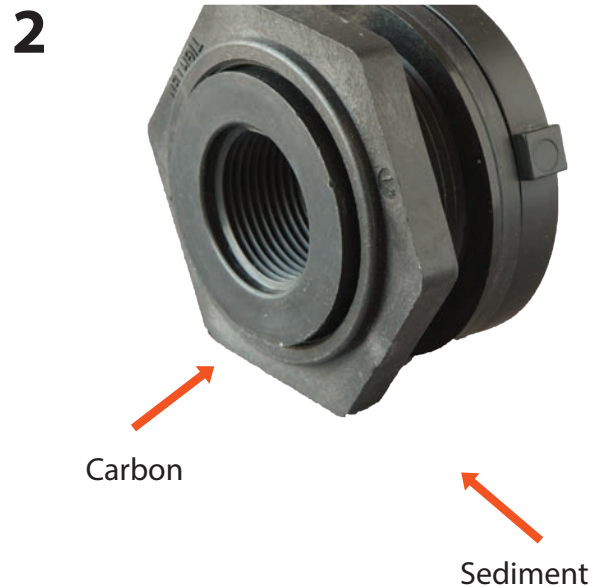

Install new sediment and carbon filter, making sure they go into the correct filter housings.



Tighten filter housings by hand, do not use filter wrench. Do not over tighten.

# XL-SCRUB SPECIFICATIONS CHARTS

## PLEATED SEDIMENT FILTER 2.5 " DIAMETER

### Materials of Construction:

- Filter Media
- End Caps
- Core
- Temperature Rating
- Non-woven Polyester
- Vinyl Plastisol
- Polypropylene
- 40°F to 125°F (4.4°C to 51.7°C)

### Size Description:

- 2.5" X 9 7/8"

### Initial AP(psi) @ flow rate (gpm):

- 1 psi @ 10 gpm(.01 bar @ 38 L/min)

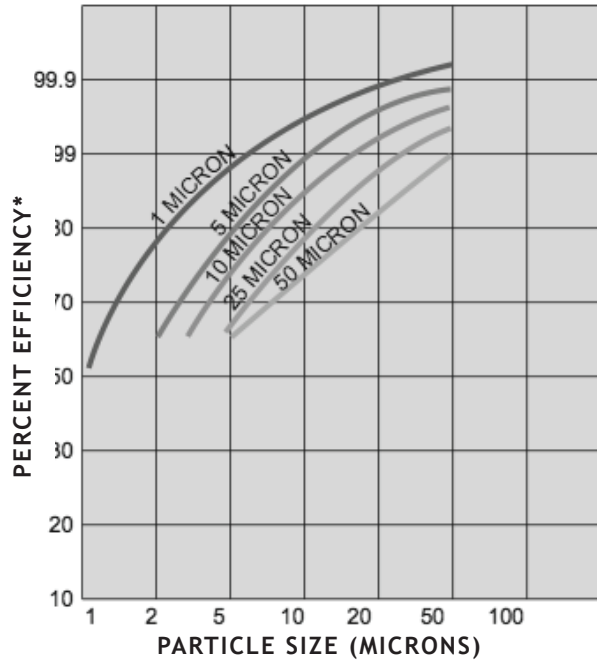

## ECO COCONUT CARBON BLOCK FILTER

### Materials of Construction:

- Carbon: NSF listed 61, Coconut Shell PAC
- End Caps: Polypropylene
- Inner/Outer Wraps: Polypropylene
- Nettings: Polypropylene
- Gaskets: NBR
- Temperature Ring: 40°F to 180°F

### OD X Length:

- 2-3/4" X 9-3/4"

### Nominal UM Rating

- 10

### Initial AP(psi) @ flow rate (gpm):

- 1 PSI @ 30 GPM

### Chlorine, Taste, Odor

### Reduction Capacity Flow

- >8,000 gallons @ 1 GPM

## FILTER HOUSINGS:

- Housing - Polypropylene
- Cap - Reinforced Polypropylene
- O-Ring - Buna-N
- Maximum Pressure - 80psi

# FLUSHING THE KDF85 CARBON FILTER



## KDF85 FILTERS DOUBLE YOUR OUTPUT AND STUFF

Growonix water filters can be upgraded with a KDF85 Catalytic Carbon Pre-Filter. The "KDF" carbon filter is a superior blend of highly reactive catalytic carbon and KDF85 process media used to remove/reduce iron, hydrogen sulfide, chlorine, chloramine, bacteria, scale, and algae.

The catalytic carbon in these filters is in a loose form, and thus will discharge a small amount of carbon dust upon initial startup. It is recommended to unhook the membrane input side and flush ten gallons of water through the carbon filter before re-connecting to the RO membrane. This will ensure no dust gets into the membrane causing premature fouling.

**XL-SCRUB USES THE CF-4520-KDF**



# GROWONIX ACCESORIES

## ELECTRIC SHUT OFF KIT



An essential add-on to almost any water filter! Shuts down feed water before the water filter. Controls on/off cycling of high pressure booster pumps. The electric shutoff kit consists of a float switch and solenoid valve. Mount the float switch in your water tank or nutrient storage tank. Install the solenoid valve on the front end of your water filter. When the tank level decreases to the desired amount, the float switch opens the solenoid valve, the booster pump (if installed) powers on, and the water system begins refilling the storage tank.

## DDP-6



The DDP-6 is the ultimate water delivery pump. With a flow rate of 6.5 GPM, the DDP-6 can move water from on end of the garden to the other in a flash. Integral as a feed pump and return pump for GrowoniX smaller nutrient top feed systems, the DDP-6 can withstand the most rigorous of duties. Built in high pressure cutoff allows for easy use with solenoid valves, manual shutoff valves, watering wands, hose sprayers, or faucets

## BP-6010



DOUBLES pure water production for the EX600, EX1000, EX600, EX1000 water filters. The pump only needs 30psi of incoming water pressure to produce the full flow rate! Low pressure cutoff to safeguard the pump against a loss of incoming water pressure. Stainless steel liquid filled 300 psi system pressure gauge. Can be controlled manually or with our electric shutoff kit.

## BP-6010-CH



DOUBLES pure water production for the GX600 and GX1000 water filters. Splash Guard™ chassis connects directly to the GX600/GX1000. The pump only needs 30psi of incoming water pressure to produce the full flow rate! Low pressure cutoff to safeguard the pump against a loss of incoming water pressure. Stainless steel liquid filled 300 psi system pressure gauge. Can be controlled manually or with our electric shutoff kit.

## FLOW BOXES



GrowoniX FlowBox is a componential add-on to any GX600/1000 or EX600/1000 that utilizes a BP Series booster pump. Equipped with highly accurate liquid flow meters, the FlowBox allows for custom tuning and fine-tuning of the system ratio. Run your system at any ratio from 3:1 to 1:1— whenever you want. System ratios change throughout the year as the weather temperatures change. Keep a perfect 1:1 all year round with a FlowBox. Flush the system with a simple twist of the stainless steel needle valve. Allows for removal of the standard drain/flush assembly. Mounts atop the GX series chassis for easy viewing and adjusting. Easy wall mounting as well.

## GXM INDUSTRIAL MEMBRANES



These Dow sheet, American made membranes are the industries most reliable and highest performing reverse osmosis elements in the world. Advanced membrane technology and manufacturing processes ensure superior quality and unmatched performance. Ultra low energy design delivers high flow and high rejection at only 80psi. A must for cold water sources. Always at an industry leading 1:1 ratio.

Flow Rate: 600 gpd high flow membrane  
Membrane replacement for GX600, EX600, EX600-T

Flow Rate: 1000 gpd high flow membrane  
Membrane replacement for GX1000 EX1000, EX1000-T

## UV STERILIZATION



Stainless steel ultraviolet filtration to remove 99.9% of micro-organisms in your water supply. A must for well water treatment, whole house filter systems, or anytime water will be stored.

## COCONUT CARBON / GREEN BLOCK

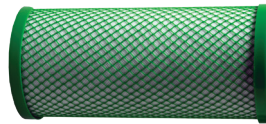

Green Coco: NFS61 Listed Greencarbon. High flow with a low carbon footprint. Superior chlorine removal..

## SEDIMENT SPUN



Spun polypropylene: A true multi-staged depth filter utilizing separate layers of micron filtration. Constructed spun polypropylene, these filters offer superior dirt holding capacity at an extremely economic price. Great filter for changing frequently, especially in well water applications, or with use in GrowoniX scrubbers.

4.5"x9.75" Spun | 16000 gallons

## SEDIMENT PLEATED

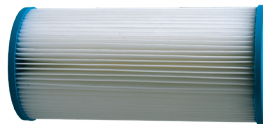

High flow pleated Sediment filter: This is a washable, reusable, and durable sediment filter with very low pressure drop. Bacteria and chemical resistant. Great for high flow applications and extended time between filter changes. Comes standard in most GrowoniX water filters.

4.5"x9.75" | 16000 gallons

## KDF85/CATALYTIC CARBON FILTER



KDF/CAT. Bacteriostatic media controls growth of microorganisms. Good for water soluble metals removal, chlorine, chloramine, and scale. Highly reactive catalytic carbon, extremely porous and long lasting.

4.5"x9.75" | 16000 gallons

# PRESSURE DIFFERENTIAL CHART

GrowoniX GX600 and GX1000 pre-filters should be changed regularly to ensure maximum membrane element life and system performance. When a 30% – 40% differential between the gauges is reached and output water pressure gauges is reached, pre-filters should be changed (i.e., when input gauge reads 80 psi and output gauge reads approximately 50 psi, you have a 30% differential—time to change pre-filters).

The pressure differential is really “pressure drop” caused by dirty pre-filters.

## IMPORTANT TIPS

- After changing filters, always turn incoming water pressure on slowly, allowing air to be discharged before full water pressure is restored.
- Be careful not to lose the O-ring when removing each filter housing bottom.

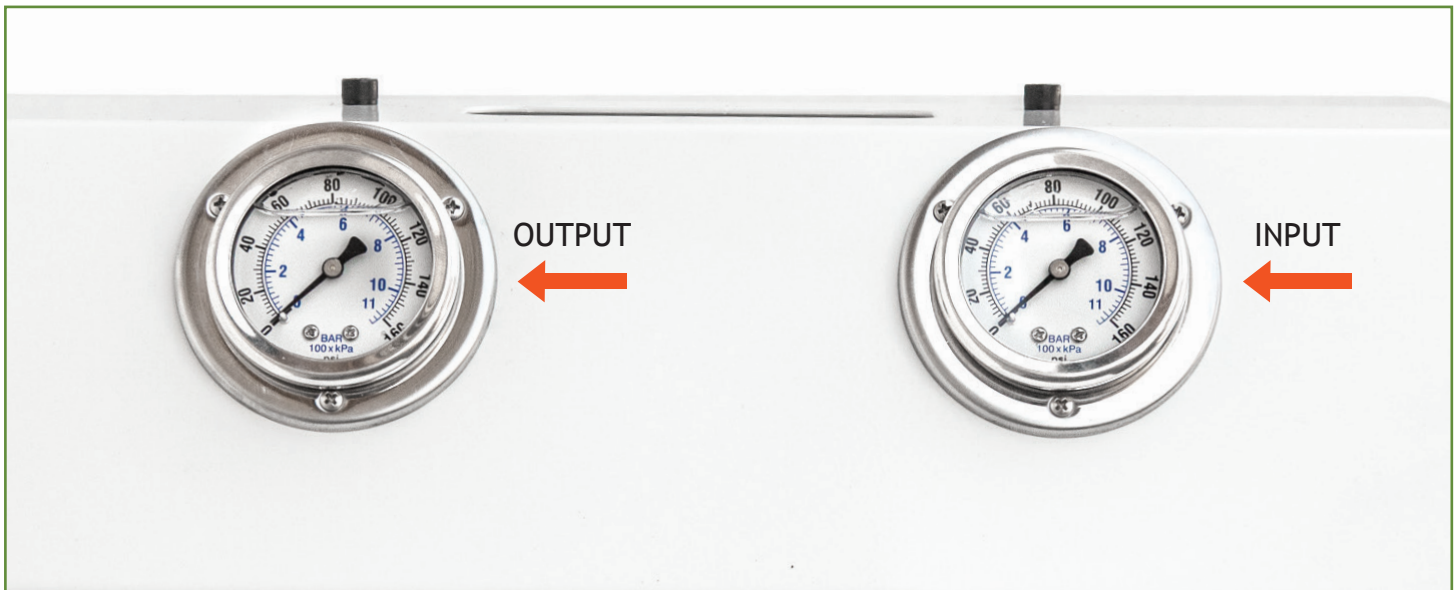

The table below displays pressure gauge readings that will assist you in knowing when to change GX Series pre-filters. Pre filters should be changed when the output pressure gauge reads 30% lower than input pressure gauge (30% pressure differential).

Input Pressure Gauge	Output Pressure Gauge	Pressure Differential
80	56	30%
75	53	30%
70	49	30%
65	45	30%
60	42	30%
55	37	30%
50	35	30%
45	31	30%
40	28	30%

# GROWONIX REVERSE OSMOSIS SYSTEM WARRANTY

For a period of one year from the date of original purchase, we will replace or repair any part of the GrowoniX reverse osmosis water system that we find to be defective in operation due to faulty materials or workmanship with the EXception of the replaceable filters and membranes.

## GENERAL CONDITIONS

Damage to any part of this reverse osmosis system because of misuse; misapplication; negligence; alteration; accident; installation; or operation contrary to our instructions, incompatibility with accessories not installed by GrowoniX, or damage caused by freezing, flood, fire, or Act of God, is not covered by this warranty. In all such cases, regular charges will apply. This limited warranty does not include service to diagnose a claimed malfunction in this unit. This warranty is void if the claimer is not the original purchaser of the unit or if the unit is not operated under normal municipal water or well water conditions.

GrowoniX assumes no liability in connection with this reverse osmosis system. GrowoniX assumes no liability for any damages incurred through the use of this product. It is the responsibility of the end user to gauge the safe use of this product in the environment where it is applied. We do not authorize any person or representative to assume for us any other obligations on the sale of this reverse osmosis system. The information given out in the manual we believe to be true, but are offered to you in good faith without guarantee because each application of this product is different and beyond our control.

THE FOLLOWING STANDARD OPERATING CONDITIONS FOR RESIDENTIAL/COMMERCIAL REVERSE OSMOSIS SYSTEMS MUST BE MET FOR WARRANTY TO BE VALID.

	Water Pressure	pH Range	Maximum TDS	Water Temp
Standard System	40-80 psi	2-11	2000 ppm	40-100 F

## GROWONIX RETURN POLICY

### MERCHANDISE RETURN DETAILS AND PROCEDURE:

If any merchandise was defective —we will refund the full purchase price upon receiving and reviewing the merchandise returned in undamaged condition.

### RMA NUMBER:

You must first obtain a Return Merchandise Authorization (RMA) number from GrowoniX.com. Any products sent to GrowoniX without an RMA number will not receive a refund and may be returned to the sender at their expense.

All refund amounts will be based on the manufacturer's warranty and GrowoniX return policy. Refunds will be issued back using the payment method you used when you placed your order. Refunds take up to 3-5 business days to process once we receive the return.

### PACKAGING:

Please kindly re-pack the product in its original box, or a box of equivalent strength. The unit should be packed in the same manner as it came to prevent damage in shipping. Please return everything that was in the original box, including any free items if applicable. Be sure to drain out all water from wet systems and parts and wrap them in plastic bags before packing.

### RETURN TO:

We will provide you with an GrowoniX warehouse address for return merchandise when we issue the RMA number.